



**PROlite** LED Lighting™

A Division of Emergensee® Lighting, Inc.



# COMING SOON

TYPE: \_\_\_\_\_ DATE: \_\_\_\_\_

JOB NAME: \_\_\_\_\_

CONTRACTOR: \_\_\_\_\_

CATALOG NO: \_\_\_\_\_

NOTES: \_\_\_\_\_

## PLED-2810

LED Flood Light

### LISTING

- UL AND CL Listed fro wet locations

### HOUSING

- Die-cast aluminum and extruded body

### LEDs

- New generation LED module

### FINISH

- UV stabilized powder coated finish

### LENS

- Optional NEMA 3, NEMA 5, NEMA 7 optics with adder

### OPTIONS

- Optional 347V with adder
- Dimmable option with adder
- Finish - Bronze, color option with adder

### DIMENSIONS

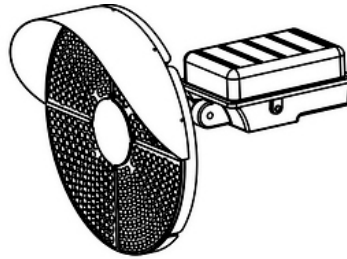
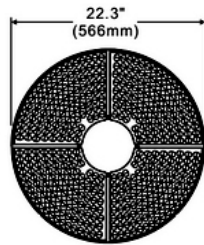
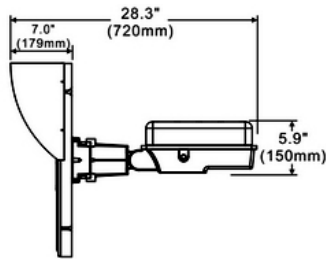

\* Different LED Kelvin temperature available with 4-6 week lead time. Please call for a quote.  
 \*\* DISCLAIMER: This test report was produced in accordance with IES LM-79 photometric testing protocol for luminaires, using a single representative test fixture. Actual production units may vary from the values reported here by up to ±10%. \*\*\* Special order only.



This powerful luminaire has been designed to meet diversified installation requirements. It can be used as a flood light and an area light. With built in heat sinks on the back of the luminaire, it provides turly spectacular light while keeping the LEDs at a cool temperature.

OPTIONAL: Kelvin color\* with adder



IP65

### ORDERING INFORMATION: EXAMPLE= ELED-2810-505W

MODEL	SYSTEM WATTS	LUMEN OUTPUT	CCT	VOLTAGE	CRI	STARTING TEMP	EQUIVALENT
PLED-2810	362W 425W 505W	54997 lm 64375 lm 76394 lm	5000K	U=120-277V	70+	-40°C	1500W MH 2000W MH 2X1500W MH