



PLV1AQ

12" Linear LED Die Cast

HOUSING

- Heavy-Duty Die Cast Aluminum Housing and Top Frame. Can Be Tapped for Side Conduit Entry
- PLV1AOQ = EasyLED Open Frame 12" Linear LED Die Cast
- PLV1AHQ = EasyLED Horizontal Hood 12" Linear LED Die Cast
- PLV1AVQ = EasyLED Vertical Hood 12" Linear LED Die Cast

FINISH

- Gray Powdercoat Finish Over a Chromate Conversion Coating. Custom Colors Available Upon Request

LENS

- Clear Polycarbonate Vandal-Resistant Lens or LumaLens Opal Polycarbonate Vandal-Resistant Lens

MOUNTING OPTIONS

- Surface Mount or Use Optional Quick-Mount Bracket

LED

- Aluminum Boards
- L_{70} @ 25°C: 187,000 HOURS

WATTAGE

- Array: 22w, System: 26.4w
- (70w HID Equivalent)
- Array: 37.2w, System: 43.4w
- (175w HID Equivalent)

DRIVER

- Electronic Driver, 120-277V, 50/60Hz
- Dimmable Driver

OPTIONS

- BU = Battery Backup
- Custom Colors Available Upon Request



The PLEPG PLV1A series wall, pendant and ceiling mount luminaire is available with clear or LumaLens lenses, and open, vertical half or horizontal half door frames designed to replace HID lighting systems from 70w to 175w MH or HPS. Typical lighting applications include retail centers, industrial parks, schools and universities, public transit and airports, office buildings and medical facilities. NSF certification meets the requirements for Food Processing Facilities. Mounting heights of to 8 feet can be used based on light level and uniformity requirements.

LISTINGS AND RATINGS

- CSA: Listed for Wet Locations
- Operating Temperatures: -40°C to +50°C
- IP66
- See Next Page for Projected Lumen Maintenance Table
- 5-Year Warranty



ORDERING INFORMATION: EXAMPLE= PLV1AOQF37U5KCGESP

MODEL	OPTICS	WATTAGE	VOLTAGE	CCT	LENS	COLOR	OPTIONS
PLV1AOQ PLV1AHQ PLV1AVQ	F=Wide	22=22w 37=37w	U = 120-277V	5K = 5000K	C=Clear Polycarbonate Vandal-Resistant Lens L=LumaLens Opal Polycarbonate Vandal-Resistant Lens	G=Gray C=Custom (Consult Factory)	ESF=Single Fuse EDF=Double Fuse ESP=Surge Protection BU = Battery Backup

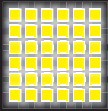

PROlite LED Lighting™

A Division of Emergensee® Lighting, Inc.

TYPE: _____ DATE: _____

JOB NAME: _____

CONTRACTOR: _____

CATALOG NO: _____

NOTES: _____

ACCESSORIES

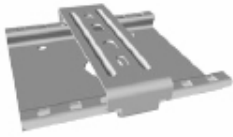

Mounting Accessories (Order separately, Field installed)

- ELVAQM Stainless Steel Quick Mount Bracket

PHOTOMETRIC DATA (WALL MOUNT)

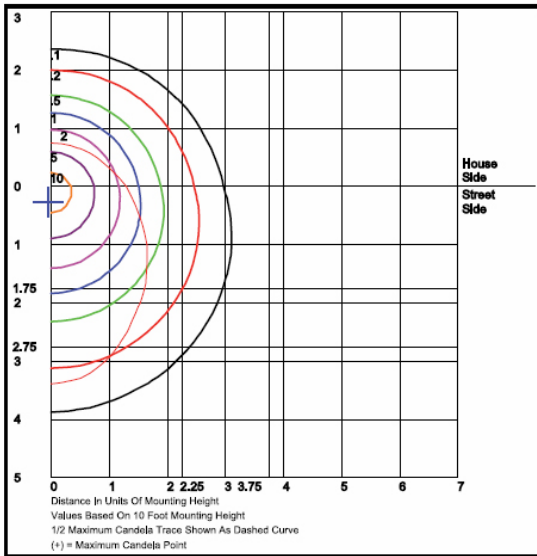

LV1AHQF37U5KL
Wide Optic

Grid in MH
MH=10 Feet

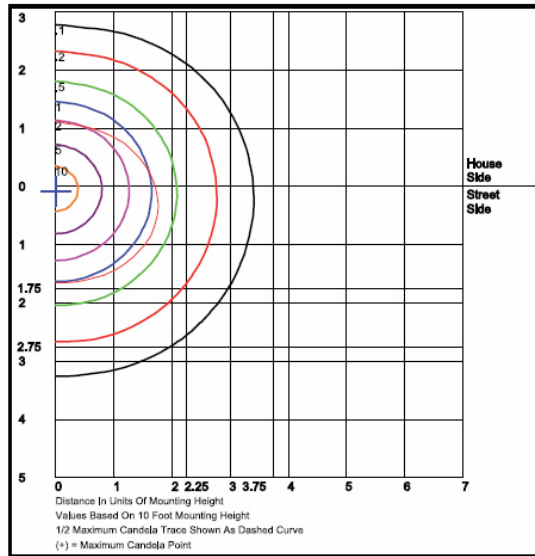

LV1AVQF37U5KL
Wide Optic

Grid in MH
MH=10 Feet

PHOTOMETRIC PERFORMANCE (WALL MOUNT)

LED Board Watts	Drive Current (mA)	Input Watts	Optics	5000 CCT 80 CRI				
				Lumens	LPW	B	U	G
EasyLED 22w (Clear Lens)	116	26	Horizontal Frame -Type III	3,126	120	1	2	1
EasyLED 22w (LumaLens)			Horizontal Frame -Type IV	2,369	91	1	3	2
EasyLED 22w (Clear Lens)			Vertical Frame -Type III	3,305	127	1	2	1
EasyLED 22w (LumaLens)			Vertical Frame -Type III	2,705	104	1	3	1
EasyLED 37w (Clear Lens)		43	Horizontal Frame -Type III	4,879	114	2	3	2
EasyLED 37w (LumaLens)			Horizontal Frame -Type IV	4,071	95	1	3	2
EasyLED 37w (Clear Lens)			Vertical Frame -Type II	5,292	123	2	3	1
EasyLED 37w (LumaLens)			Vertical Frame -Type II	4,399	102	2	3	2

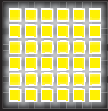

PHOTOMETRIC DATA (CANOPY/CEILING MOUNT)

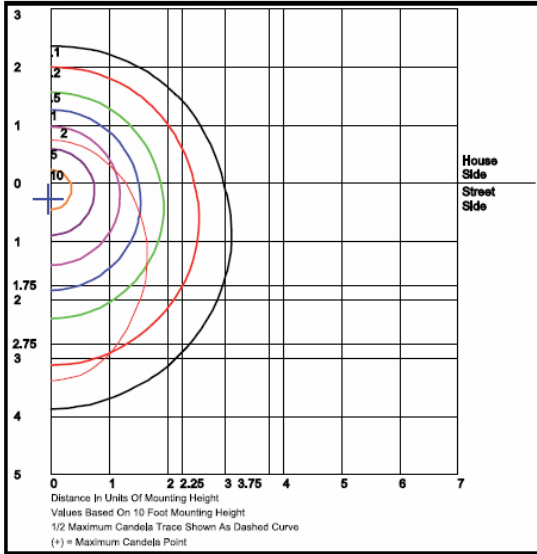

LV1AHQF37U5KL
Wide Optic

Grid in MH
MH=10 Feet

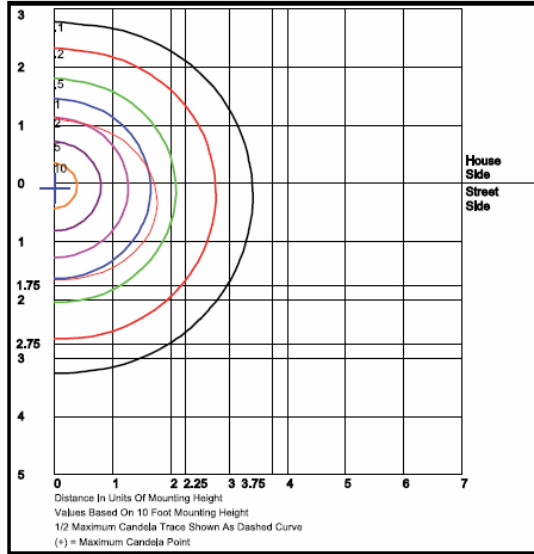

LV1AVQF37U5KL
Wide Optic

Grid in MH
MH=10 Feet

PHOTOMETRIC PERFORMANCE (CEILING MOUNT)

LED Board Watts	Drive Current (mA)	Input Watts	Optics	Spacing Criteria	5000 CCT 80 CRI	
					Lumens	LPW
EasyLED 22w (Clear Lens)	116	26	Open Frame (110° x 110°)	1.34	3,332	128
EasyLED 22w (LumaLens)			Open Frame (110° x 120°)	1.26	2,945	113
EasyLED 37w (Clear Lens)		43	Open Frame (110° x 110°)	1.26	5,538	129
EasyLED 37w (LumaLens)			Open Frame (110° x 120°)	1.26	4,948	115

PROJECTED LUMEN MAINTENANCE

Data shown for 5000 CCT			Compare to MH			
TM-21-11	Input Watts	Initial	25,000 Hrs	50,000 Hrs	100,000 Hrs	Calculated L70@ 25°C
L70 Lumen Maintenance @ 25°C / 77°F	26	1.00	0.96	0.92	0.84	187,000
L70 Lumen Maintenance @ 25°C / 77°F	43	1.00	0.96	0.92	0.84	187,000
TM-21-11	Input Watts	Initial	25,000 Hrs	50,000 Hrs	100,000 Hrs	Calculated L70@ 50°C
L70 Lumen Maintenance @ 50°C / 122°F	26	1.00	0.94	0.88	0.75	121,000
L70 Lumen Maintenance @ 50°C / 122°F	43	1.00	0.93	0.86	0.72	109,000
TM-21-11	Input Watts	Initial	25,000 Hrs	50,000 Hrs	100,000 Hrs	Calculated L80@ 40°C
L80 Lumen Maintenance @ 40°C / 104°F	26	1.00	0.95	0.89	0.79	94,000
L80 Lumen Maintenance @ 40°C / 104°F	43	1.00	0.94	0.88	0.79	84,000

NOTES:
 1. Projected per IESNA TM-21-11. Data references the extrapolated performance projections for the 116mA base model in a 25°C ambient, based on 10,000 hours of LED testing per IESNA LM-80-08.
 2. Compare to MH box indicates suggested Light Loss Factor (LLF) to be used when comparing to Metal Halide (MH) systems.