

# POCKET COLLECTION

## SPECIFICATIONS

- 120-277V INPUT VOLTAGE, 50/60Hz
- CONSTANT CURRENT AT 700 mA
- CLASS 2 DRIVER POWER FACTOR >.9
- AMBIENT OPERATING TEMPERATURE -40°C (-40°F) TO +40°C (105°F)
- ESTIMATED 50,000 HRS L<sub>70</sub>\*
- THERMALLY PROTECTED LED ARRAY
- FITTER NECK ACRYLIC DIFFUSER
- MOLDED OF DURABLE NON-CORROSIVE UV RESISTANT RESINS
- UL/CUL LISTED FOR WET LOCATION
- STANDARD PACK QTY: 6



RoHS compliant

**FP103**



EXTENDS: 5 3/4"  
HCMT: 2 3/8"

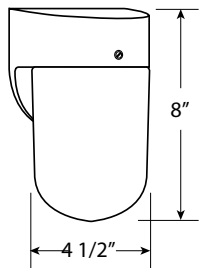

**FP106**



EXTENDS: 6 1/2"  
HCMT: 2 3/8"

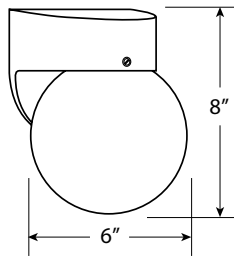

**FP109**



EXTENDS: 5 3/4"  
HCMT: 2 3/8"

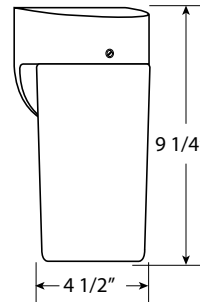

**FP123**



EXTENDS: 7"  
HCMT: 4 1/4"

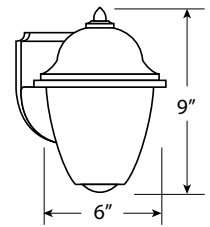

EXAMPLE # FP103-L900C-BW

STYLE #	SOURCE/WATTAGE	LUMENS/CCT	BODY	DIFFUSER
FP103 = HARBOR	L900 = 4 CREE LED ARRAY (10W) 11.3W POWER INPUT CRI = 74 (TYP) 80 LUMENS PER WATT **	C = 912lm 4000K	B = BLACK W = WHITE	W = WHITE
FP106 = GLOBE				
FP109 = LONG BEACH				
FP123 = ACORN				

L900C LED REPLACEMENT PARTS	
L09C-DC-700-04-R	= 4 CREE LED ARRAY
IG900-DMV-1	= LED DRIVER

\* DATA PER LM79/LM80/TM21 AVAILABLE UPON REQUEST



A Division of Emergensee® Lighting, Inc.